



**विदर्भ कोकण ग्रामीण बँक**  
**Vidharbha Konkan Gramin Bank**

भारत सरकार, बँक ऑफ इंडिया आणि महाराष्ट्र शासनाचा उपक्रम  
Govt. of India, Bank of India & Govt. of Maharashtra Undertaking

VKGB/SRO/A & S /WEBTENDER/06/06

DATED 19.01.2018.

**TENDER NOTICE FOR ELECTRIC WIRING AND LAN CABLING WORK AT PROPOSED  
NEW PREMISES AT JEUR BRANCH**

1. Vidharbha Konkan Gramin Bank, Regional Office, Solapur is inviting sealed tender of Furniture work of proposed Branch at Kumbhari, Tal – South Solapur, Dist.-Solapur. Sealed tenders should be addressed to "The **Regional Manager, Vidharbha Konkan Gramin Bank, Regional Office, Solapur, "Gurukrupa Sankul", Plot No. 23, Nehru Nagar, Vijapur Road, Solapur – 413004. Contact Nos.0217-2305721, 2305722 & 0217-2305744.**
2. Tenders should superscribed "**TENDER FOR ELECTRIC WIRING AND LAN CABLING WORK AT PROPOSED JEUR BRANCH**" and should reach to us from 22/01/2018 to 31/01/2018 but not later than 2.00 p.m. No Tender will be accepted after given date and time.
3. Only those contractors / firms who are on the panel of the Bank or erstwhile Vidharbha Kshetriya or Wainganga Kshetriya Gramin Bank, Nationalized Bank are eligible to participate in this tender.
4. Following documents are required to be submitted with tender,
  - a) Registration certificate of the firm / company.
  - b) Copy of audited statement of current financial year.
  - c) PAN Card / GSTIN NO.
  - d) Full details of the Bank Account.Tenders received without stated documents are **not considered** for the process.
5. Tenders will have to quote their rate for all items given in measurement sheet and its abstract. Conditional tenders are liable for rejection.
6. The tender shall be valid for a period of 30 days from the last date of submission.
7. The Bank is not bound to accept the lowest tender and reserve the right to accept the tender either in full or in part of any tender. The Bank also reserves its right to reject all the tenders without assigning any reason thereof.
8. Electrical and LAN cabling lay out, Description & measurement of electrical items and list of approved material to be used are enclosed with this notice

**(K.R.Telmasre)**  
**Regional Manager,**  
**Vidharbha Konkan Gramin Bank,**  
**Solapur Region.**

Regional Office:- "GurukrupaSankul" Plot No.23, Nehru Nagar, Bijapur Road, Solapur- 413004  
Ph. 0217-2305721,2305722,Fax -0217-2305622. Website: www.vkgb.co.in,E-mail: vkgb.rosol@gmail.com



**TENDER FOR PROPOSED ELECTRICAL, DATA CABLING AND UPS WORKS  
FOR JEUR BRANCH, VIDHARBHA KONKAN GRAMEEN BANK.**

Sr. No.	ITEM DESCRIPTION	QTY.	RATE	UNIT	AMOUNT
<b>ELECTRICAL WORKS</b>					
1	<b>LIGHT POINT</b> Providing and fixing light points and making connection in casing caping upto to switch board with 1 sq.mm wire of finolèx company complete	34		EACH	-
2	<b>CEILING FAN</b> Providing and fixing ceiling fan 48" dia brown colour (Crompton /Usha/Orient) company with step dimmer, shakti hook and pipe as required making and proper connection upto control	6		EACH	-
3	<b>CEILING FAN</b> Providing and fixing ceiling fan 36" dia brown colour (Crompton /Usha/Orient) company with step dimmer, shakti hook and pipe as required making and proper connection upto control	6		EACH	-
4	<b>STEP DIMMER</b>	12		each	-
5	<b>WALL FAN</b> Providing and fixing wall fan (12") of Vista /Remi company with step dimmer and making proper connection upto control on switch board.	1		EACH	-
6	<b>EXHAUST FAN</b> Providing and fixing after making an opening in wall exhaust fan and making proper connection upto control on switch board and finishing the opening with proper plaster and color to match the walls.	2		EACH	-
7	<b>TUBE LIGHTS</b> Providing & fixing 1 X 36 watt energy saver electronic tube set with tube set with tube of Phillips/Wipro make on wall.	17		EACH	-
8	<b>CFL TUBES</b> Providing and fixing 15 W CFL BULBS in toilet area as indicated in drawings.	1		EACH	-
9	<b>15 A POWER POINT</b>				-
10	1) Providing and fixing 16A Power point as shown in drawing.	3		EACH	-
11	<b>TELEPHONE POINT</b> Providing and fixing telephone point as per design.	3		EACH	-
12	<b>TELEPHONE CABLE</b>	150		rft	-



13	<b>DISTRIBUTION BOARD (D.B.)</b> Providing and fixing distribution board with distributing the load as per Amp capacity (6 to 32Amp) company siemens/Havells.				
A	SPMCB	6		EACH	-
B	DPMCB	2		EACH	-
13	<b>SUB- METER BOARD</b> Providing and fixing control sub- meter of 32A/230V I.C.D.P.Main switch of super/ESCO company	1		EACH	-
14	<b>EARTHING</b> Providing and making single phase earthing in earth pit (3' .0 x3' .0x 4' .0) by using salt, coal, Copperplate size 4mm sq.copper plate size 1' .0 x 11.0 x 8 Nos. wore earthing outlet.	1		EACH	-
15	<b>CIRCUIT MAIN</b> Providing and fixing circuit main				
a	1.5 sq.m.	600		RFT	-
b	2.5 sq.m	280		RFT	-
c	4.0 sq.m	100		RFT	-
16	<b>BELL FITTING</b> Providing and fixing bell push button in banking area.	2		EACH	-
17	<b>RYB INDICATORS FITTING</b> Providing and fixing RYB indicator and fixing RYB indicator	3		EACH	-
18	<b>16A THREE PIN TOP</b> Providing and fixing 3 Pin Tops in wherever required.	1		EACH	-
	<b>SUB- TOTAL</b>				-
<b>DATA CABLING</b>					
1	Providing and fixing & laying LAN CABLE for computer networking ( cable should be of CAT 6Type)	650		rft	-
2	Providing and fixing I/O BOX Of CAT 6 TYPE	6		EACH	-
3	Providing and fixing of 2m patch cord from I/O BOX to computer, (patch should be machine crimped . Preferably patch cord & LAN cable should be of same make D link)	6		EACH	-
4	Crimping each Lan cable on switch side with R.J. Connector. Should be of sandard Company make	6		EACH	-
5	<b>EARTHING FOR UPS</b> Providing and making single phase earthing in earth pit (3'x3'x6') by using salt, coal copper cable size 2.5mm SQ, copper plat, etc including earthing wire etc.	2		EACH	-
6	6A. UPS. plug point Providing and fixing plug points and makingconnecting in casing capping up to Switch board with 1.5sq.mm wire of Finolex /R.R. cable Company, complete	15		EACH	-

7	16 A. UPS. Point Providing and fixing points and making connection in casing capping up to Switch board with 2.5sq.mm wire of Finolex /R.R. cable Company , complete	2		EACH	-
SUB-TOTAL					-
TOTAL					-

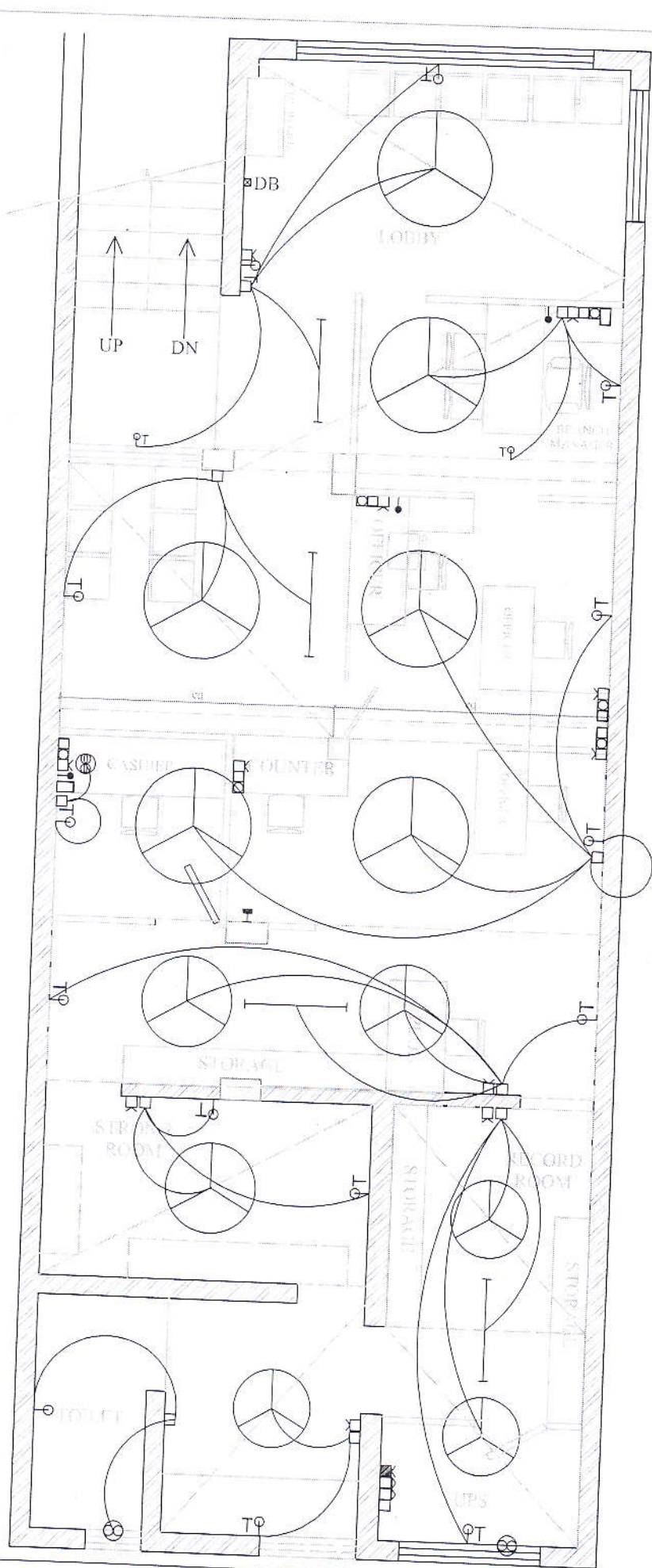

LEGEND	
	SWITCH BOARD
	WALL POINT
	TUBELIGHT
	TUBELIGHT
	6A SOCKET
	16A SOCKET
	INVERTER POWER POINT
	DISTRIBUTION BOX
	TELEPHONE
	EXHAUST
	CEILING FAN
	BELL SWITCH
	RINGER
	COMPUTER POINT
	LAN CABLE POINT

ELECTRICAL PLAN

INTERIOR DESIGN FOR VKGB, JEUR BRANCH.

NORTH

ARCHITECT

28.10.2017

AR. SHVETA S. KOTHAVALE  
 ARCHITECT AND INTERIOR DESIGNER  
 "PUSHKAR", 18, SARVODAYA SOCIETY,  
 OLD HATCH

