



विदर्भ कोकण ग्रामीण बँक
Vidharbha Konkan Gramin Bank

भारत सरकार, बँक ऑफ इंडिया आणि महाराष्ट्र शासनाचा उपक्रम
Govt. of India, Bank of India & Govt. of Maharashtra Undertaking

VKGB/SRO/A&S/WEBTENDER/04/04

Date :- 13/01/2016

TENDER NOTICE FOR FURNITURE WORK OF VAIRAG BRANCH

1. VidharbhaKonkanGramin Bank, Regional Office, Solapur are inviting sealed tender of Furniture work of Branch – Vairag, Tal – Barshi, Dist.-Solapur. Sealed tenders should be addressed to " **The Regional Manager, Vidharbha Konkan Gramin Bank, Regional Office, Solapur, "Gurukrupa Sankul", Plot No.23, Nehru Nagar, Vijapur Road, Solapur – 413004. Contact Nos.0217-2305721,2305722& 0217-2305744.**
2. Tenders Shouldsuper scribed"**TENDER FOR FURNITURE FOR VAIRAG BRANCH**" and should reach to us on or before 08/02/2016 not later than 2.00 p.m. No Tender will be accepted after given date and time.
3. Only those contractors / firms who are on the panel of the Bank or erstwhile Vidharbha Kshetriya or Wainganga Kshetriya Gramin Bank, Nationalized Bank are eligible to Participate on this tender.
4. Following documents are require to be submit with tender,
 - a) Registration certificate of the firm / company.
 - b) Copy of audited statement of current financial year.
 - c) PAN Card.
 - d) Full details of the Bank Account.Tenders received without stated documents are not considered for the process.
5. Tender will have to quote their rate for all items given in measurement sheet and its abstract. Conditional tenders are liable for rejection.
6. The tender shall be valid for a period of 30 days from the last date of submission.
7. The Bank is not bound to accept the lowest tender and reserve the right to accept the tender either in full or in part of any tender. The Bank also reserve its right to reject all the tenders without assigning any reason thereof.
8. Furniture lay out, Description & measurement of furniture items and list of approved material to be used are enclosed with this.

(A.P. Bansode)

Regional Manager,
Vidharbha Konkan Gramin Bank,
Solapur Region.

Regional Office:- "GurukrupaSankul" Plot No.23, Nehru Nagar, Bijapur Road, Solapur- 413004
Ph: 0217-2305721,2305722,Fax -0217-2305622. Website: www.vkgb.co.in,E-mail: vkgb.rosol@gmail.com



BILL OF QUANTITIES

Name of the Project :- Proposed Furniture work for Vidharbha Konkan Gramin Bank, **Vairag Branch**, Tal: Barshi, Dist: Solapur.

SR. NO.	ITEM OF WORK	QUANTITY	Rate Rs. Per Quantity / Unit	Total Amount Rs.
1	Bank Counter Providing and Fixing Bank Counter using 18 mm comm. Ply for structure 12 mm com.ply for back, all exterior faces should be finished with 1 mm thick laminate and internally with enamel paint counter should have storage, drawers, key board 12 mm thick clear glass of 1 ft height should fixed vertically above counter etc. complete (As directed by Bank Architect) L = 19'3" B = 2'6" H = 2'6"	19.25 RFT		
2	B.M. Cabin partition with Glass Providing and Fixing Bank Counter of 18 mm ply structure 06 mm com.ply both sides with 1 mm laminate partly glazed with 6/8/12 mm glass fixed in TW beadin. Partition should have doors with door closures and SS Handles including locking arrangement. (As directed by Bank Architect) L = 7'3" x H = 4'0" (Front side)	29.20 Sq.Ft		
3	B M Side Partation Providing and fixing front partition using 18 mm structure and 6 mm ply with 1 mm laminate 12 mm thick clear glass with necessary openings at front face with aluminium grill etc. complete. (As directed by Bank Architect) L = 10'4" x H = 4'0"	41.60 Sq.Ft		
4	Cash cabin Side Partition Providing and fixing partition for cash cabin using 18 mm comm.ply structure 6 mm ply with 1 mm laminate partly glazed with 6 mm glass / aluminium grill partition should have door with locking arrangement etc. complete. (As directed by Bank Architect) a) Cash Front Partition - L = 5'0" X H=7'0" b) Side Partition - L = 7'6" X H=7'0" c) Strong Room Partition - L = 10'0" x H = 9'6"	35.00 Sq.ft 52.50 Sq.Ft 95.00 Sq.ft.		
5	Storage (Cupboard) Near Cash Cabin (Full Storage) L = 5'0" B = 1'6" H = 7'0"	35.00 Sq.ft		
6	Alluminium Mesh Counter Side 3'2"x2'8" = 8.40 Front Side 3'6"x3'3" = 11.37 Top 8'2" x 4'6" = 36.72 Door 1'9"x2'3" = 3.93 Total 60.42 Sq.ft.	60.42 Sqft		
7	B.M.Table Providing and fixing table using 18 mm comm.ply structure 12 mm ply for front side externally finished with 1 mm laminate internally finished with enamel paint. Table should have storage, drawers and keyboards etc. complete. (As directed by Bank Architect) (front =5'6"x 2'6"x2'6") (side =3'0"x1'6"x2'6")	1 No.		
8	Officer Table Providing and fixing table using 18 mm comm.ply structure 12 mm ply for front side externally finished with 1 mm laminate internally finished with enamel paint. Table should have storage, drawers and keyboards etc. complete. (As directed by Bank Architect) (front = 5'0"x2'3"x2'6") (side =3'0"x1'6"x2'6")	1Nos.		
9	Chairs Providing and supplying revolving chairs using moulded foam for seat and back covered with approved fabric high back for B.M. (As directed by Bank Architect)			
	B. M.	1 No.		
	Officer and Clerk	5 Nos.		
	Visitors	5 Nos.		
	Perforated Three Seater for Customer waiting	2 Nos.		
10	Writing Table with Challan Tray	1 No.		
11	Suggestion Box	1 No.		
	Total :-->			

(Rs. _____ only)

 Manager () Manager (A&S) Manager (Plan.) Sr. Manager

15 HEAD OFFICE, A&S (PREMISES CELL)
LIST OF APPROVED MANUFACTURERS/PRODUCTS

S.NO. PRODUCTS	MANUFACTURERS
1. Suspended Ceiling	- INDIA GYPSUM, GYPSUM, ARMSTRONG
2. Teakwood	- Best quality C.P.teak wood/Ivory cost. well seasoned free from Sap, knots, Cracks, Uniform in colour.
3. 6/12mm, Plywood	- KITPLY, CENTURY, GREENPLY TRUWOOD, PRE-LAM BOARD - SAMRAT, ARCHIDPLY, MARS, NARROTAM,BAJAJ
4. 19mm Plywood	- KITPLY, CENTURY, GREENPLY TRUWOOD, PRE-LAM BOARD - SAMRAT, ARCHIDPLY, MARS, NARROTAM,BAJAJ
5. 1mm Laminates	- (Texture finish- BAIC PRICE RS 1200/- PER SHEET) EURO,ROYALE-TOUCH,GREEN - LAM CENTURY, FORMICA,SUN-MICA
6. Glass	- Modiguard, Saint-Gobain
7. Hardware	- Ebco, Earl Behari, Vision
8. Locks	- Godrej/ VISION/ HARRISON
9. Door closers and floor springs	- Everite, Sandhu/ Hardwyn
10. Adhesive (for wood)	- Fevicol, Vemicol-HV
11. Paints	- Nerolac, Asian, ICI
12. Wood Preservatives	- Wood guard, Termisl, Dursban wood
13. Vertical Blinds	- Vista Levelor, Trac, Muc.
14. Telescopic Sliding channels	- Earl Behari, Ebco.
15. Flooring tile	- Restile, Johnson, Niteo
16. Tile Adhesive	- Pidilite, Roff

Note: Other material as per BIS/ISI standard approved by the bank/Architect

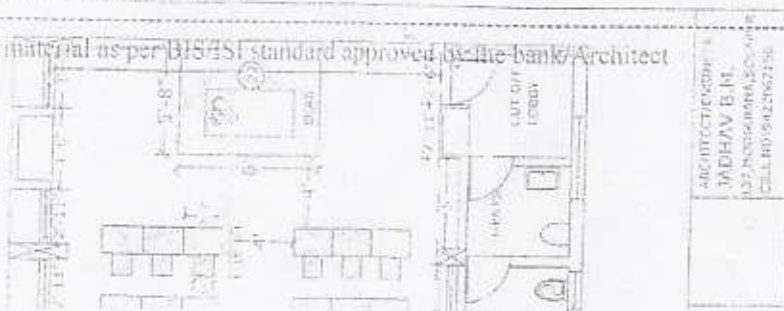

 Manager () Manager (A&S) Manager (Plan.) Sr. Manager